

Note : This holding is exclusive of surface areas of any Mining Lease issued under the Mining Act that may exist from time to time.
Improvements and topographic details compiled from _____ photography, have been shown to assist in the location of the un-surveyed
boundaries of the lease which are approximate only.
By use of digitizing equipment, the current derived area of the holding is 321 square kilometres.

YARRONVALE H.
324 km² (Balance Area)
Ex Roads

SCALE: 1:100 000

PREPARED BY THE DEPARTMENT OF MAPPING AND SURVEYING, QUEENSLAND. CROWN COPYRIGHT RESERVED.

L.A.D. :	CHARLEVILLE	MAPS: 1:100 000 7944 (Prov.) & 8044 (Prov.)
SHIRE :	MURWEH	
RUN: 1357	PAST. DIST :	WARREGO
BEARINGS ARE ON C.A.M. (APPROX.)		
Drawn: R.E.B.	Checked: A.G.D.	P.H.1674
Date: 7.1.81	Calc Book 1429/25	
SUPERSEDES P.H.648		

ATTACHMENT 1B1



PH 1674

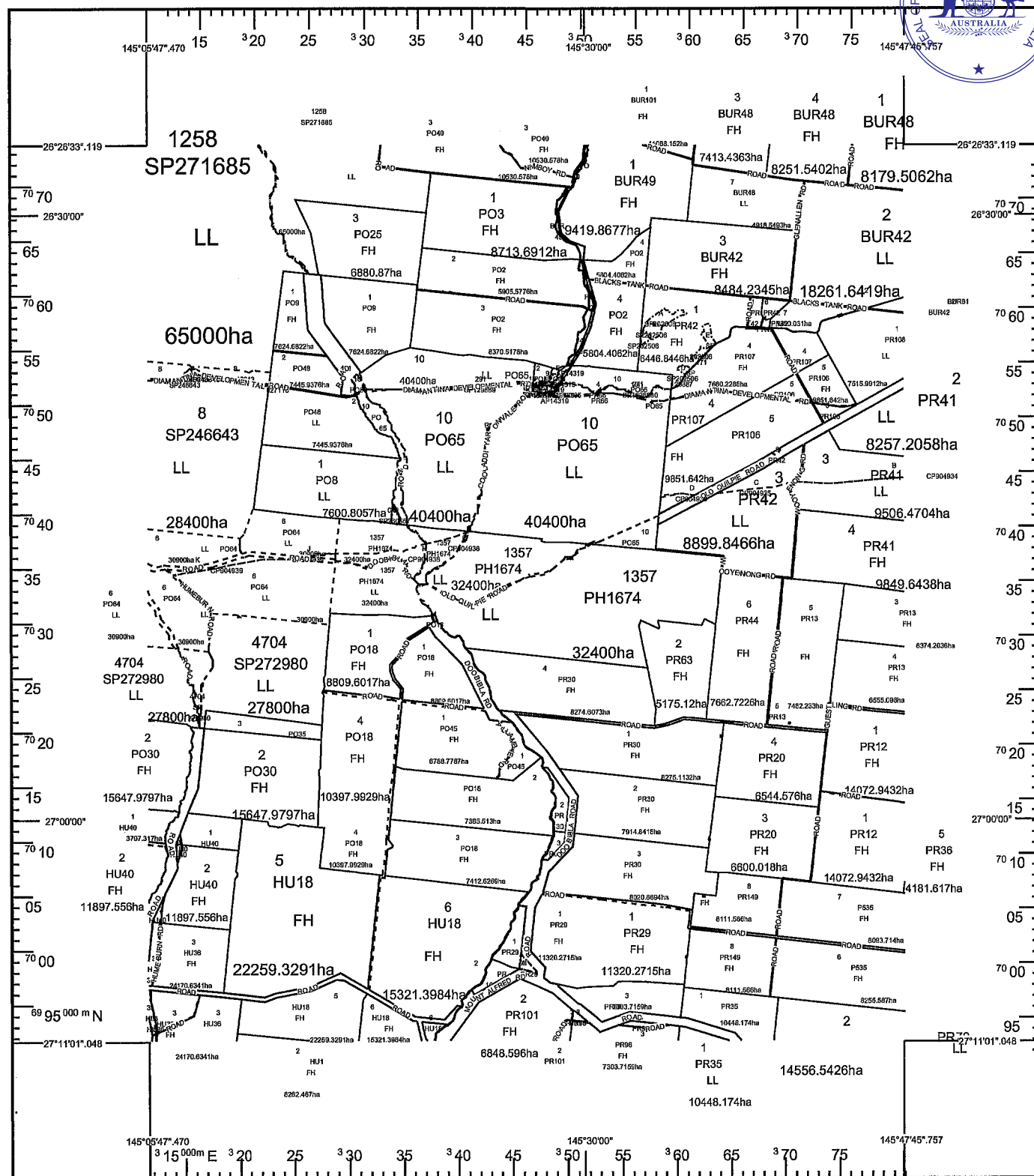

145°26'46".614
26°48'47".083
COOLADDI
19.20 KM

CLIENT SERVICE STANDARDS

PRINTED 22/01/2024

DCDB 20/01/2024 (Lots with an area less than 8,000ha are not shown)

Users of the information recorded in this document (the Information) accept all responsibility and risk associated with the use of the Information and should seek independent professional advice in relation to dealings with property.

Despite Department of Resources best efforts, RESOURCES makes no representations or warranties in relation to the Information, and, to the extent permitted by law, exclude or limit all warranties relating to correctness, accuracy, reliability, completeness or currency and all liability for any direct, indirect and consequential costs, losses, damages and expenses incurred in any way (including but not limited to that arising from negligence) in connection with any use of or reliance on the Information

For further information on SmartMap products visit
<https://www.qld.gov.au/housing/buying-owning-home/property-land-valuations/smartmaps>

SmartMap

An External Product of
SmartMap Information Services

Based upon an extraction from the
Digital Cadastral Data Base



**Queensland
Government**

(c) The State of Queensland,
(Department of Resources) 2024.

